

WELLGLASS

EVCC-PR Series - Tank lighting fixtures - Copper free aluminium



Tank inspection lights suitable for ON-SHORE and OFF-SHORE application by suitable painting cycle (upon request).

TECHNICAL FEATURES

Material	Aluminium with low content of copper
IP rating	IP66
Ambient temperature range	-52°C to +60°C
Approvals	Certified 01ATEX0019X (standard) IECEX INE 15.0031X TR CU (marking upon request, ordering code to be required)
Marking	II 2 GD Ex d IIC T3 Gb Ex tb IIIC T200°C Db IP66
Gaskets	O-ring made of Nitrile Rubber (NBR)
Surface treatment	Green colour polyurethane painting cycle RAL6003 (other colour available upon request)
Entries	N° 2 entries M25x1,5 (plugs and cable glands excluded)
Included accessories	AISI304 Stainless steel external hardware and screws
Lamps	Included
Rated operation voltage (UE)	230V (standard) 220V, 240V (marking upon request)
Frequency	50/60 Hz
Optional accessories	Fixing flange for porthole

Dimensions EVCC-PR

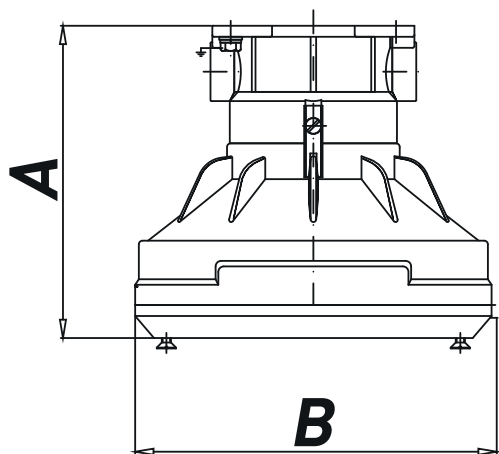

(EVCC-PR) Tank inspection lights

TYPE	CODE	LAMP [W]	WEIGHT [Kg]	TEMP. CLASS	DIMENSIONS [mm]	
					A	B
EVCC-PR2/HA 42	A044621E2171D	42	3.10	T4	153	165
EVCC-PR3/HA 53	A044631F3171D	53	4.40	T4	170	195